

**Contents**



Refill package



Pot

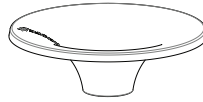

Lid

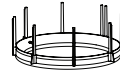

Floater



Time indicator cap

**Assembly**



Fill the pot with 3.5 - 4.5 liters (±1 gallon) of clean tap water. For placement details see other side of this sheet.



**Shake the refill package thoroughly** and open it by tearing at the notches. Gently take out the powder-coated piece of gauze.

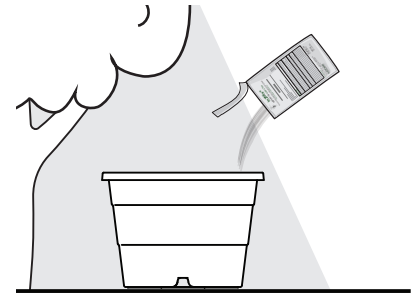

Empty the remaining contents (powder and odor tablets) of the refill package into the water of the trap. Avoiding the gauze from getting wet.

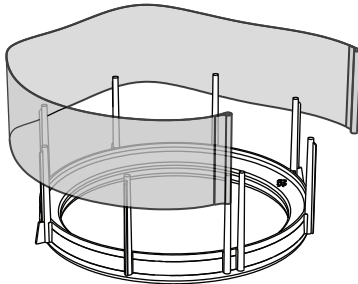

Slide the loop at the ending of the gauze over the pin as shown. Try not to touch the gauze extensively to avoid removal of the active powders.

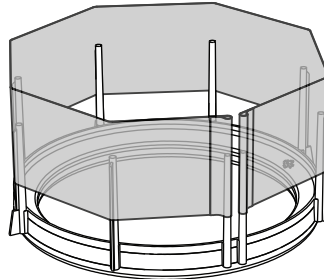

Wrap the gauze around the floater and slide the other gauze loop on the last pin as shown. Work your way around moving the gauze down at each pin.

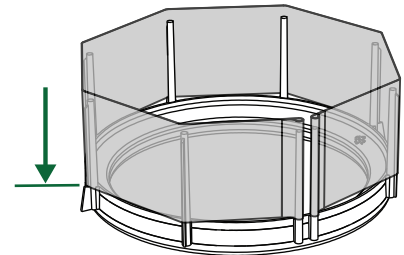

Push the gauze down the pins until it will go no further (where the bottom of the pin hits the circular rib). The rib will prevent the gauze from sliding too far.

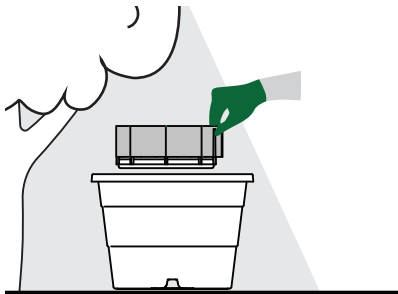

Put the gauze-carrying floater inside the trap by gently placing it over the central tube flat onto the water. Prevent the gauze from getting wet as water will degrade the powder.

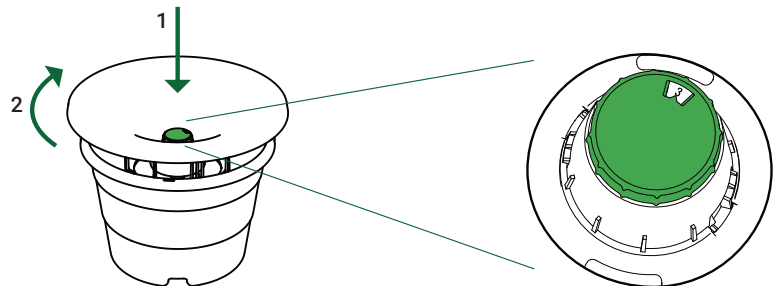

Place the lid on the central tube, push it down and turn it clockwise.

Turn the time indicator to the number of the current month as a service reminder.



**Note:** The In2Care Mosquito Trap does not immediately kill adult mosquitoes. The contents of the trap therefore may not contain high numbers of dead mosquitoes. However, the trap kills the mosquito larvae that emerge from the eggs that are laid inside the trap, prior to larvae transforming into adult mosquitoes. This means that small living larvae may be encountered in the trap. The exiting adult female mosquito itself is contaminated, so that she can carry powder to other breeding sites (in the vicinity of the trap). She will be killed by the powder after a few days.

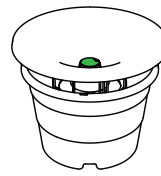

**Placement**

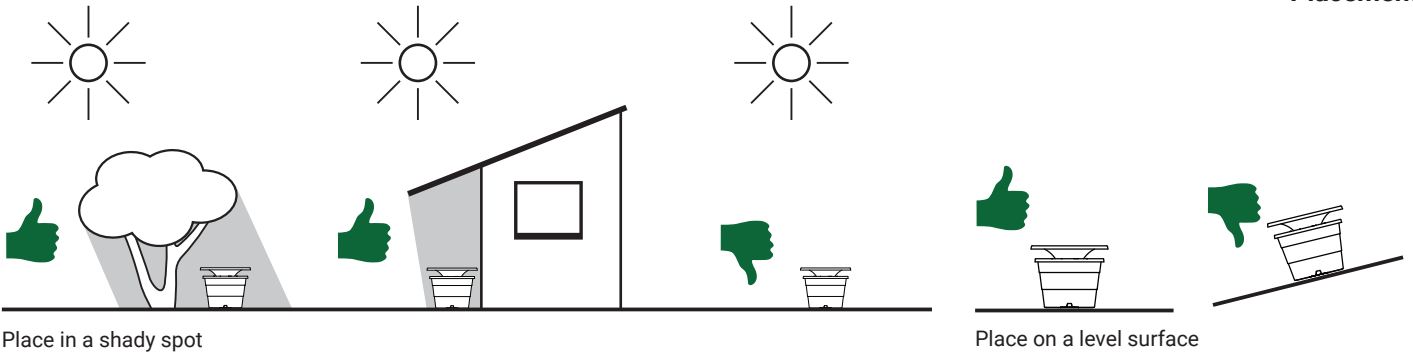

Place in a shady spot

Place on a level surface

**Recommendations**

For an optimal efficacy of the In2Care Mosquito Trap, ensure high trap coverage (1 trap per 400m<sup>2</sup>/10-15 per acre) in the selected treatment area and remove other mosquito breeding sites as much as possible.

Remove and/or empty artificial water containers (flower pots, plastic cups, sewage drains, septic tanks, car tires, etc.) and natural breeding sites (puddles, tree holes etc.). Larger water bodies that cannot be removed or emptied should be (frequently) treated with appropriate mosquito larvicides.

We recommend outdoor trap placement in shaded areas, close to human habitation/houses. In dry areas, check the water level inside the trap regularly and add more water when needed.



Evenly distribute traps over available space

**Maintenance**

Re-visit each trap every 4 weeks.

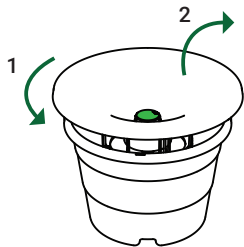

Remove the lid by turning it counter clockwise until the stop and lift it.

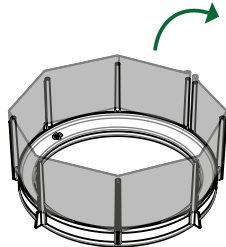

Take out the floater and discard the used gauze. (follow the instructions on the refill package)

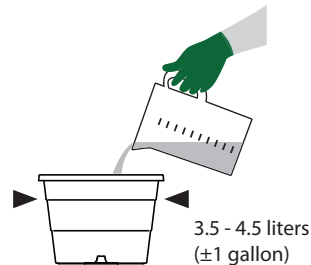

3.5 - 4.5 liters (±1 gallon)

Remove leaves or other debris that may have fallen into the water and refill the trap with clean tap water.



Take a new refill package and repeat the assembly steps as described on the other side of this manual.

**Fixating**

When traps are disturbed by animals, stability can be improved by fixating the trap to the ground using a zip tie or the wire bracket, available separately from the distributor, which snaps onto the pot.

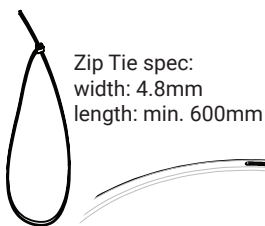

Zip Tie spec:  
width: 4.8mm  
length: min. 600mm

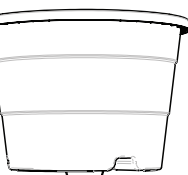
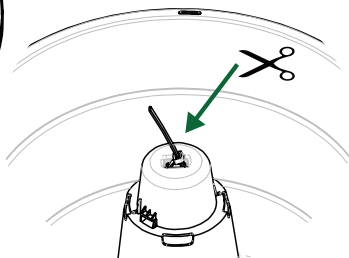

The loop can be tied to a ground pin or hook

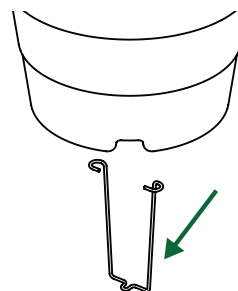

The wire bracket can be screwed onto a surface or fixed with a ground pin.

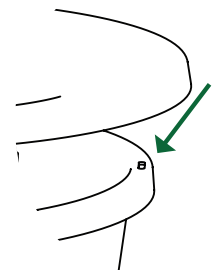

Another fixation option is to use the holes in the rim of the pot and tie the pot to a pole or tree using a zip tie or a small rope.